

CONFIRMATORY PLAT OF
 QUEEN'S LANDING
 COMMUNITY MARINA
 FOURTH ELECTION DISTRICT
 QUEEN ANNE'S COUNTY, MARYLAND
 PREPARED FOR QUEEN'S LANDING COMMUNITY MARINA, LLC

OWNERS CERTIFICATION
 QUEEN'S LANDING COMMUNITY MARINA, LLC, OWNER OF THE PROPERTY SHOWN HEREON, DOES HEREBY ADOPT THIS PLAT OF AMENDMENT FOR UNIT C13 TO BE RELOCATED TO THE NEW LOCATION IS SUBJECT TO THE DECLARATION OF QUEEN'S LANDING COUNCIL OF UNIT OWNERS, INC. RECORDED OR TO BE RECORDED AMONG THE LAND RECORDS OF QUEEN ANNE'S COUNTY, MARYLAND, CONTEMPORANEOUSLY WITH THE RECORDATION OF THIS PLAT.

QUEEN'S LANDING COMMUNITY MARINA, LLC
 BY: ROBERT HOLLAND, MARINA COMMITTEE MEMBER
 8/22/2023 DATE

OWNERS CERTIFICATION
 FRANK E. HOLGERSON AND THERESA A. HOLGERSON, OWNER OF SLIP UNIT C13, DOES HEREBY ADOPT THIS PLAT OF AMENDMENT FOR UNIT C13 TO BE RELOCATED AND IS SUBJECT TO THE DECLARATION OF QUEEN'S LANDING COUNCIL OF UNIT OWNERS, INC. AND ACKNOWLEDGE THE SAME TO BE OUR ACT AND DESIRE THE PLAT TO BE RECORDED ACCORDING TO LAW IN QUEEN ANNE'S COUNTY, MARYLAND.

FRANK E. HOLGERSON JR.
 THERESA A. HOLGERSON
 8/22/2023 DATE
 8/22/2023 DATE

UNIFORM ACKNOWLEDGMENT ACT

STATE OF Maryland
 COUNTY OF Talbot
 ON THIS 22 DAY OF August, 2023, BEFORE ME, THE UNDERSIGNED OFFICER, PERSONALLY APPEARED FRANK E. HOLGERSON JR. & THERESA A. HOLGERSON KNOWN TO ME (OR SATISFACTORILY PROVEN) TO BE THE PERSON WHOSE NAME IS SUBSCRIBED TO THE WITHIN INSTRUMENT AND ACKNOWLEDGED THAT HE EXECUTED THE SAME FOR THE PURPOSES THEREIN CONTAINED, IN WITNESS WHEREOF I HEREBY SET MY HAND AND OFFICIAL SEAL.



Notary Signature
 NOTARY PUBLIC

OWNERS
 QUEEN'S LANDING MARINA, LLC
 401 QUEEN'S LANDING DRIVE
 CENTERVILLE, MARYLAND 21617
 CONTACT: ROBERT HOLLAND

OWNERS SLIP C13
 FRANK E. HOLGERSON JR. AND THERESA A. HOLGERSON
 501 MONTANA DRIVE
 LINCOLN UNIVERSITY PA 19352

ENGINEER/SURVEYOR
 MCCRONE
 RYAN ANDERSON, PROF. L.S.
 330 PENNSYLVANIA AVENUE
 CENTREVILLE, MARYLAND 21671
 PHONE: (410) 758-7237

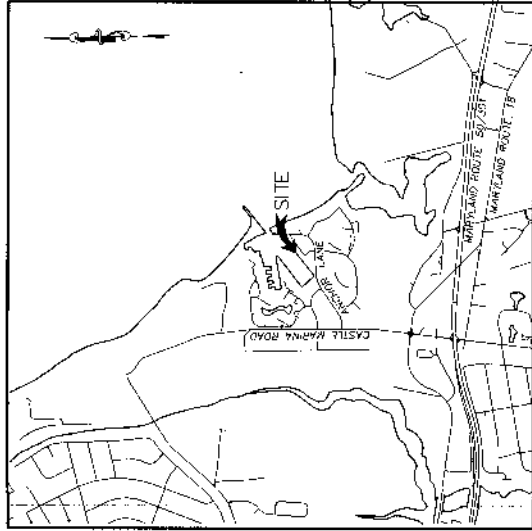

PURPOSE STATEMENT

THE PURPOSE OF THIS CONFIRMATORY PLAT IS TO REMOVE THE EXISTING LOCATION OF SLIP C13 AND RELOCATE IT TO A NEW LOCATION. THIS WILL NOT BE CREATING A NEW SLIP IN THE MARINA.

SURVEYORS CERTIFICATION

THIS IS TO CERTIFY THAT THIS MAP OR PLAT AND THE SURVEY ON WHICH IT IS BASED WERE MADE IN ACCORDANCE WITH THE MARYLAND MINIMUM STANDARDS FOR BOUNDARY SURVEYS. CERTIFICATION UNDERSIGNED FURTHER CERTIFIES A PROFESSIONAL OPINION, AS A LAND SURVEYOR REGISTERED IN THE STATE OF MARYLAND, THE RELATIVE POSITIONAL ACCURACY OF THIS SURVEY DOES NOT EXCEED THAT WHICH IS SPECIFIED THEREIN.

Surveyor Signature
 RYAN WILLIAM ANDERSON
 REGISTERED PROFESSIONAL SURVEYOR
 REGISTRATION NO. 22071
 EXPIRATION DATE: 03/27/25

SITE NOTES

- PROPERTY SHOWN HEREON IS DESIGNATED CURRENTLY AS TAX MAP 49, GRID 20, PARCEL 36.
 SITE ADDRESS: 501 QUEEN'S LANDING DRIVE
 CHESTER, MD 21619
- FOR DEED REFERENCE SEE 19340351
 - FOR PLAT REFERENCE SEE LIBER 41 FOLIO 27.
 - THIS PLAN WAS PREPARED WITHOUT THE BENEFIT OF A TITLE REPORT.
 - THE SITE IS PARTIALLY LOCATED WITHIN THE FLOOD PLAIN ACCORDING TO THE FEDERAL EMERGENCY MANAGEMENT AGENCY'S F.I.R.M. MAP FOR QUEEN ANNE'S COUNTY, PANEL NO. 24039C0310D DATED NOVEMBER 5, 2014.
 - THIS SITE IS LOCATED ENTIRELY WITHIN THE OCEASAPAKE BAY CRITICAL AREA - ZONED (IDA) LIMITED DEVELOPMENT AREA.
 - FOLLOWING RELOCATION OF SLIP C13, THE PREVIOUS ESTABLISHED SLIP AREA IS DISSOLVED AND IS NOT TO SERVE AS ABOUT SLIP
 - THIS PLAT DOES NOT NEED SUBDIVISION APPROVAL.

THIS IS NOT A SUBDIVISION

Professional Certificate. A surveyor certifies that this information was prepared in accordance with the laws of the State of Maryland. Under the laws of the State of Maryland, a surveyor must be a member of the State of Maryland Surveyors Association. Registration No. 22071.

SEAL *8/22/23* DATE

MCCRONE
 ENGINEERS • SURVEYORS • PLANNERS
 ANNAPOLIS • CENTREVILLE • ELKTON • SALISBURY • OMAHAWAY
 100 PENNSYLVANIA AVENUE
 CENTREVILLE, MARYLAND 21617
 410.758.7237
 www.mccrone-engineering.com

DATE:	AUGUST, 2023
SCALE:	AS SHOWN
JOB NUMBER:	11101
DRAWN BY:	REVISION
DESIGNED BY:	DATE
FOUNDER NAME:	REVISION

CONFIRMATORY PLAT
 T.M. 49, GRID 20, PARCEL 26
 QUEEN'S LANDING COMMUNITY MARINA
 SLIP C 13
 FRANK AND THERESA HOLGERSON
 4TH ELECTION DISTRICT, QUEEN ANNE'S COUNTY, MARYLAND
 PREPARED FOR: FRANK AND THERESA HOLGERSON

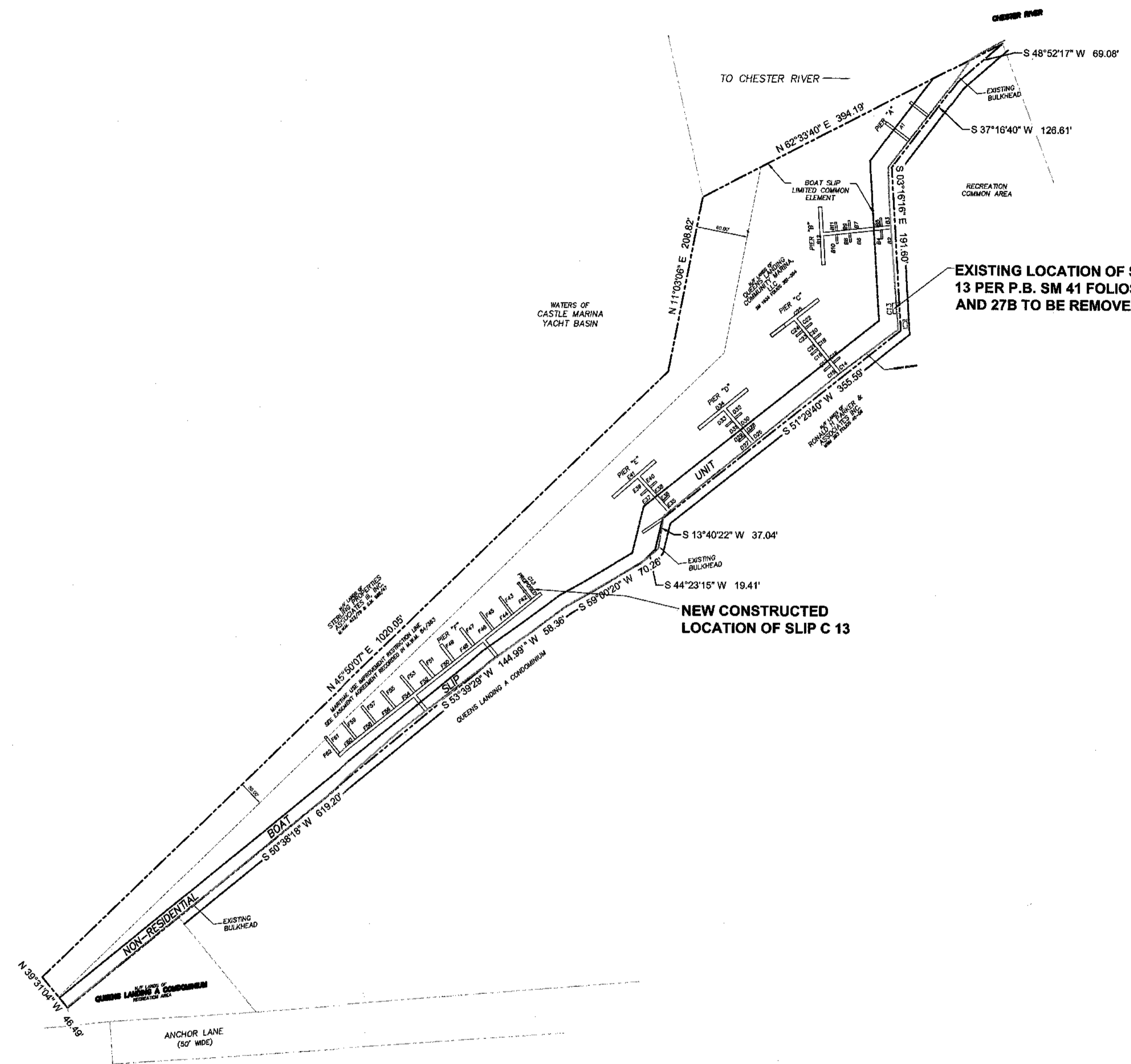

SURVEYORS CERTIFICATION

THIS IS TO CERTIFY THAT THIS MAP OR PLAT AND THE SURVEY ON WHICH IT IS BASED WERE MADE IN ACCORDANCE WITH THE "STATE OF MARYLAND MINIMUM STANDARDS FOR BOUNDARY SURVEYS." CERTIFICATION, UNDERSIGNED FURTHER CERTIFIES THAT IN MY PROFESSIONAL OPINION, AS A LAND SURVEYOR REGISTERED IN THE STATE OF MARYLAND, THE RELATIVE POSITIONAL ACCURACY OF THIS SURVEY DOES NOT EXCEED THAT WHICH IS SPECIFIED THEREIN.

Ryan William Anderson
 RYAN WILLIAM ANDERSON
 REGISTERED PROFESSIONAL SURVEYOR
 REGISTRATION NO. 22071
 EXPIRATION DATE: 03/27/25

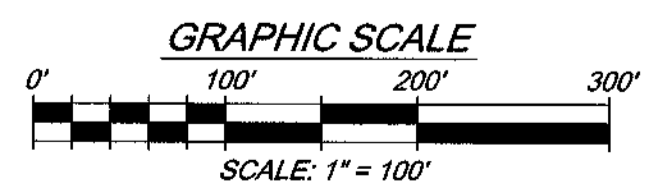

PURPOSE STATEMENT

THE PURPOSE OF THIS AMENDED PLAT IS TO REMOVE THE EXISTING LOCATION OF SLIP C13 AND RELOCATE IT TO A NEW LOCATION. THIS WILL NOT BE CREATING A NEW SLIP IN THE MARINA.

THIS IS NOT A SUBDIVISION

CONFIRMATORY PLAT

T.M. 49, GRID 20, PARCEL 26
 QUEENS LANDING COMMUNITY MARINA

SLIP C 13
FRANK AND THERESA HOLGERSON

4TH ELECTION DISTRICT, QUEEN ANNE'S COUNTY, MARYLAND
 PREPARED FOR: FRANK AND THERESA HOLGERSON

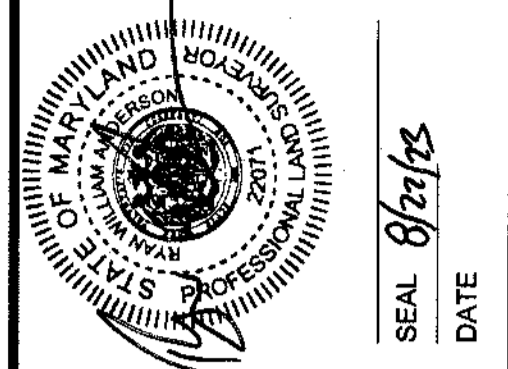

Professional Certification. I hereby certify that these documents were prepared or approved by me, and that I am a duly licensed Professional Land Surveyor under the laws of the State of Maryland, License No. 220071, Expiration Date: 3-27-2025.

McCRONE
 ENGINEERS ■ SURVEYORS ■ PLANNERS
 ANNAPOLIS ■ CENTREVILLE ■ ELKTON ■ SALISBURY ■ DELAWARE

320 PENNSYLVANIA AVENUE
 CENTREVILLE, MARYLAND 21617
 410.758.2237

Copyright © 2022
 www.mccrone-engineering.com

DATE:	AUGUST, 2023	SCALE:	1" = 100'
JOB NUMBER:	D1230085	DRAWN BY:	RWA
FOLDER REF:	1118 QL	DESIGNED BY:	RWA
DATE		REVISION	